

General Specifications

Cleaning Systems
Model FC20

pH/ORP

For industrial applications and particularly for automatic process measurements it is of the greatest importance that the sensitive part of a glass electrode and the flow diaphragm of a reference electrode are kept clean.

Often it is not practical to interrupt a process for cleaning the electrodes, an accurate indication is required over a long period, replacing the electrodes is difficult, etc. Then an automatic cleaning mechanism may be the solution.

Yokogawa manufactures two different cleaning systems for pH and/or ORP (Redox) measurements:

- Chemical cleaning.
- Mechanical cleaning.

The cleaning elements have standardised dimensions for mounting in flow- and immersion fittings.

FEATURES

- Designed for in-line electrode cleaning in flow- and immersion fittings of Yokogawa.
- Restricts sediment formation on the electrodes and increases the period between cleaning.
- Optimum cleaning effect.
- Standardised dimensions for mounting in an electrode hole of a fitting.



SYSTEM CONFIGURATION

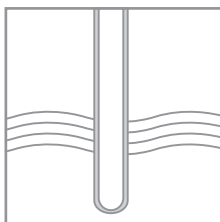

Sensors

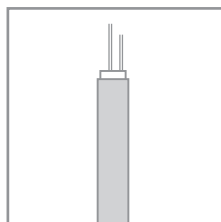

Cables

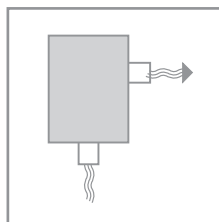

Fittings

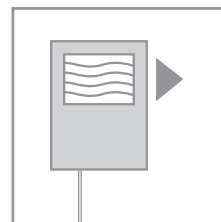

Transmitters

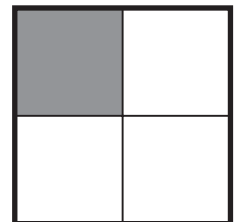

Accessories

A. CHEMICAL CLEANING SYSTEM

The chemical cleaning system is effective in processes where deposits can be removed by a suitable solvent. Good cleaning effects can be obtained from periodically spraying of an electrode. EXA pH402 has a built-in wash timer with programmable wash time, interval time and relaxation time for automatic cleaning of the electrodes, preventing pollution of the pH sensitive parts. After washing, it is possible to check the response time of the electrodes.

A built-in (no return) nozzle in the spray unit prevents penetration of the process liquid in the cleaning system.

The standardised dimensions allow mounting in the (4-hole) flow and immersion fittings of Yokogawa.

FEATURES

- The EXA pH402 analyzer has a built-in timer and HOLD circuit.
- Built-in (no return) nozzle to prevent penetration of the process liquid into the cleaning system.

SPECIFICATIONS

SPRAY UNIT

Materials

Body	: Glass filled epoxy
Nozzle	: Polyvinylidene fluoride (PVDF)
Mounting gland	: Polyvinylidene fluoride (PVDF)
Fixing screw	: Polyvinylidene fluoride (PVDF)
O-rings	: Silicone rubber

Connection

: 1/4" OD tubing

Process conditions

: Max. 1 MPa (10 bar) at 100 °C

Weight

: Approx. 100 g

Mounting

: In flow- and immersion fittings (4-hole) of Yokogawa

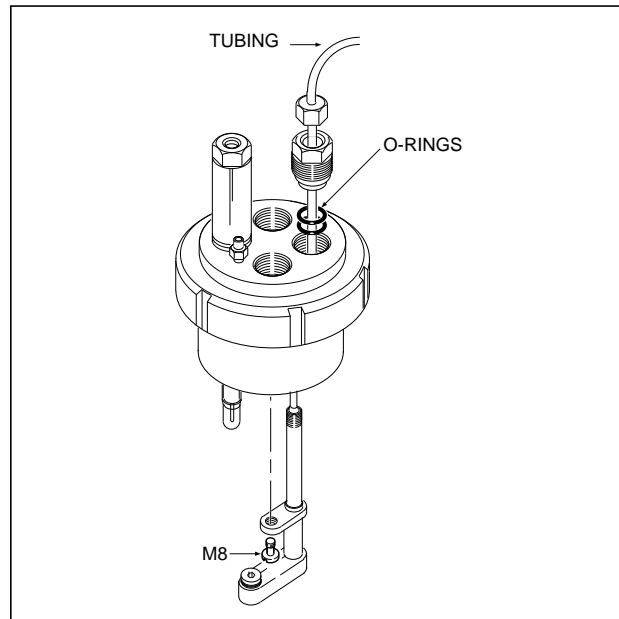

Fig. 1. Chemical cleaning system

B. BRUSH CLEANING SYSTEM

The brush in this cleaning system periodically strikes along the sensitive membrane of the measuring electrode, so that this part is wiped frequently, preventing sediment formation on it.

The flow of measuring solution is not obstructed and interruption of measurement during cleaning is not necessary.

The brush cleaning system is activated electrically or pneumatically.

The standardised dimensions allow mounting in the (4-hole) flow- and immersion fittings of Yokogawa.

FEATURES

- Minimum maintenance by static sealing of brush movement.
- Pneumatically or electrically driven.
- Easy replaceable brush.
- Brush height adjustable for optional cleaning effect.

SPECIFICATIONS

BRUSH HOLDER

Material

Body (see fig.)	: a. Stainless steel AISI 316
	: b. Epoxy
	: c. Silicone rubber
	: d. Epoxy resin

Brush : Horse hair (in PVDF holder)

Process conditions : Max. 1 MPa (10 bar) at 100 °C

Weight : Approx. 120 g

Mounting : In flow- and immersion fittings (4-hole) of Yokogawa

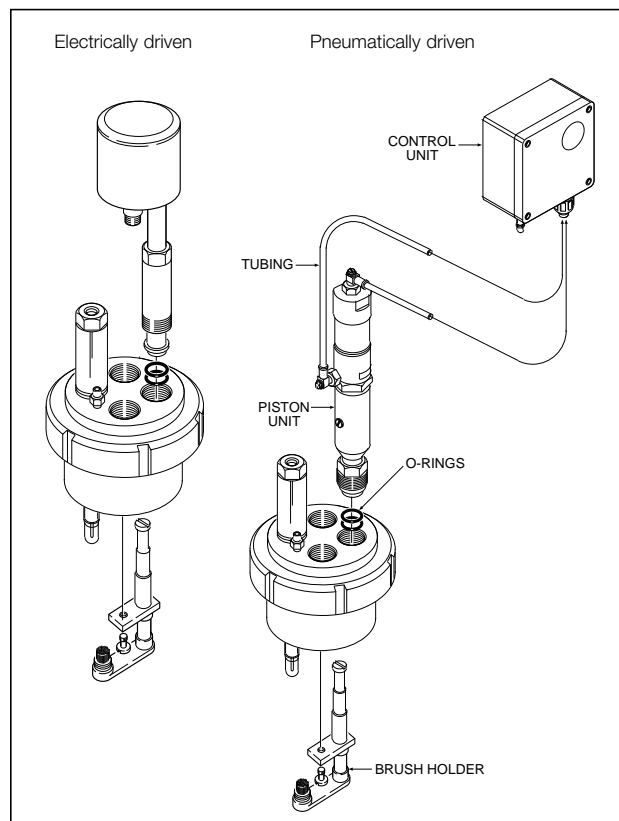

Fig. 2. Electrically/pneumatically driven brush cleaning

DRIVING MECHANISM (electrical)**Supply**

- Voltage : 24 V AC ($\pm 10\%$);
for 10 V/220V AC a power supply,
type BC10 is available
- Frequency : 50/60 Hz
- Consumption : Max. 4 VA

Cleaning frequency : 2 Strokes per minute

Angle : Rotation of 40° (swing)

Electrical connection : Gold plated spring O connector (for
standard cable, model WU20)
screw thread: $\frac{1}{4}$ " BSPP

Material

- Driving system : Stainless steel AISI 316
- Driving shaft : Stainless steel AISI 316
- Cap : Silicone rubber
- Connector : Polyvinylidene fluoride (PVDF)
- Mounting nut : Ryton R4

Weight : Approx. 1 kg

DRIVING MECHANISM (pneumatical)**1. Piston unit**

Air supply : Via the connected control unit

Cleaning frequency : $\frac{1}{4}$... 2 strokes per minute
(adjustable on the control unit)

Angle : Rotation 40°

Air connectors

(IN 1 and IN 2) : \varnothing 4 mm (external)

Material

- Body : Brass
- Mounting gland : Stainless steel AISI 316

Weight

: Approx. 1 kg

2. Control unit

Air supply : 140 kPa (1.4 bar) pressurized air

Ambient temperature range

: -10 to + 60°C

Housing

- Material : Aluminium case with chemical
resistive lacquer IP65
- Entries : Air connector \varnothing 6 mm
- Dimensions : See dimensional drawings
- Mounting : Wall mounting (for fixing
dimensions see dimensional
drawings)
- Weight : Approx. 2.5 kg

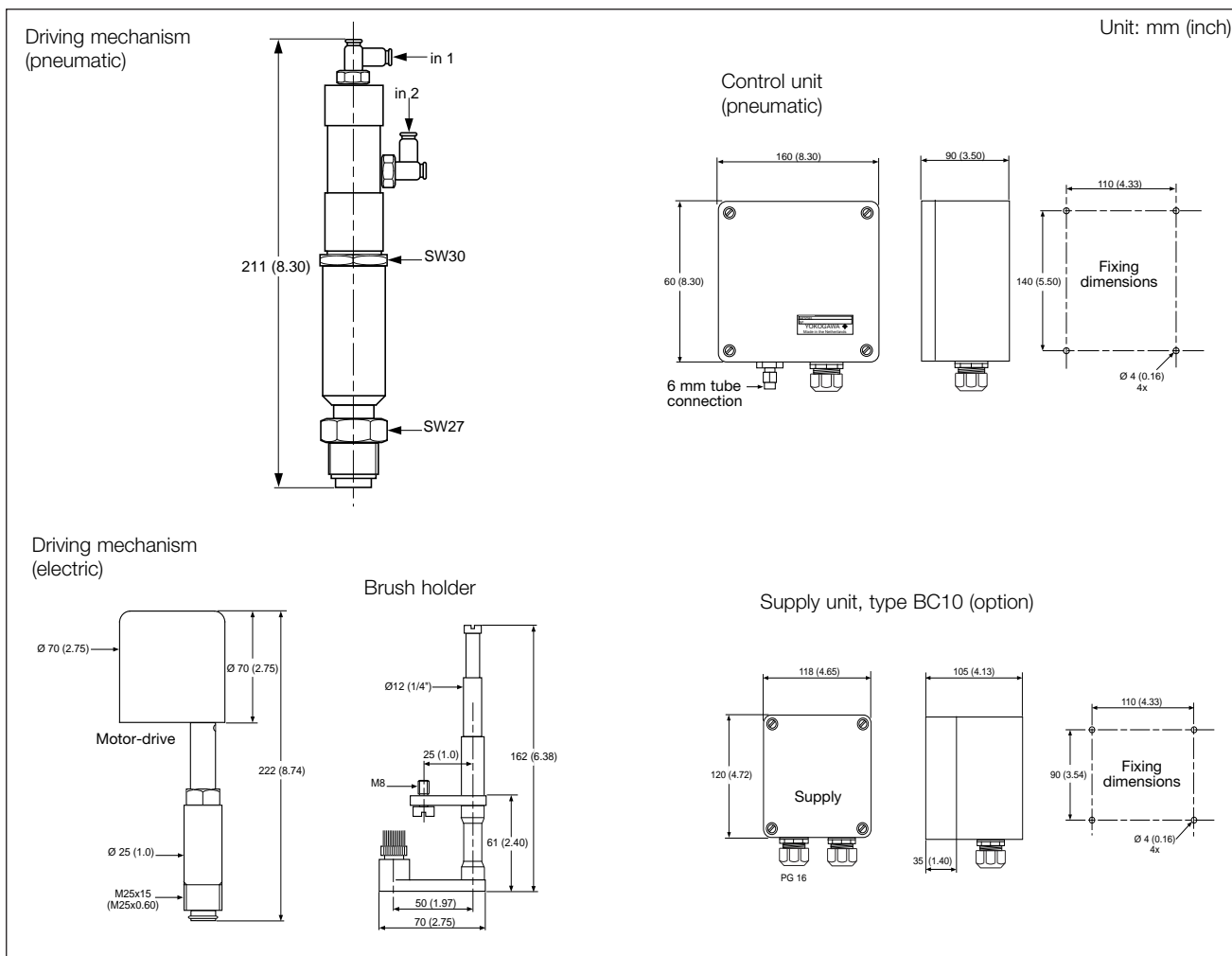
DIMENSIONS Brush cleaning

DIMENSIONS Chemical cleaning

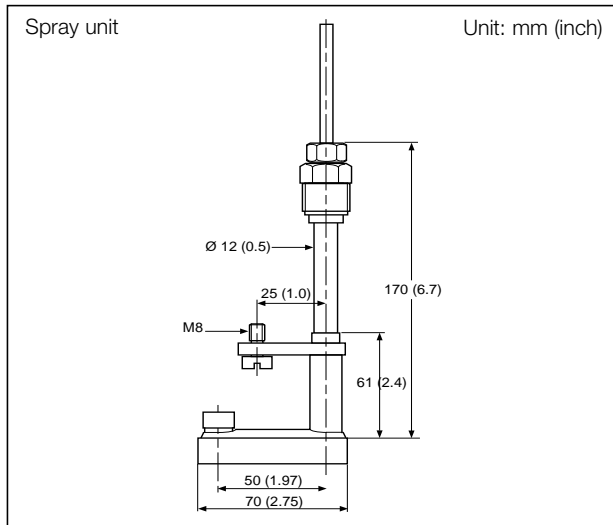

MODEL AND CODES

Model	Suffix code	Options code	Description
FC20	Cleaning system
Design	-VE	Brush cleaning (electrical driven)
	-VP	Brush cleaning (pneumatically driven)
	-ECN2	Chemical cleaning
Options		/T	10 m nylon tubing 6.35 mm OD (0.25) 1.27 mm thickness (0.05)
		/PH5.....	5 meter tubing
		/PH10....	10 meter tubing

SELECTION CRITERIA

Applications with:	Mechanical		Chemical	
	Brush	Acid	Base	Emulsifier
Oils, fats				X
Resins (wood, pulp)			X	
Emulsions of latex	X			
Fibers (paper, textile)	X			
Crystalline precipitations (carbonates)	X	XX		
Amorphous precipitations (hydroxides)	X	XX		

ACCESSORIES AND OPTIONS

Type	Description
WU20-PC02	COAX-cable (2 m) for FC20-VE
WU20-PC05	COAX-cable (5,5 m) for FC20-VE
WU20-PC10	COAX-cable (10 m) for and FC20-VE
BC 10	Supply unit (220/24 V AC) for motor of FC20-VE

SERVICE PARTS

Type	Description
K1520 NA	Tubing (ø 4 mm) Brush cleaning (pneumatically driven)
82895279	O-ring (11 x 3) for mounting in electrode holes (8 pieces)
FP20-R12	Mounting set (Ryton R4) for mounting in electrode holes
K1520 NB	Brush for mechanical cleaning
K1520 NF	Motor unit for electrically driven brush cleaning
K1520 NG	Brush holder for mechanical cleaning
K1520 NH	Piston for pneumatically driven brush cleaning
K1520 NJ	Control unit for pneumatically driven brush cleaning
K1520 FK	Tubing ø 1/4" chemical cleaning 10 m, tubing suitable for the wash noggle
K1500 ZF	Mounting set tubing 1/4"
K1520 ND	Transducer for ultra-sonic cleaning
K1520 NE	Generator for ultra-sonic cleaning

ORDERING INSTRUCTIONS

When ordering, specify model and code, item name and part numbers:

- Cleaning system : FC20-VE, FC20-VP or FC20-ECN2
- Accessories : Type number and description (quantity)
- Service parts : Type number and description (quantity)
- Flow fittings (4-hole): FF20-P43, FF20-S43 or FF20-F43
- Immersion fitting (4-hole)
: FD20-P47, FF20-S47 or FF20-F47
(refer to separate sheets)
- Subassembly flow fitting (4-hole)
: FS20-V42 or FS20-S42

YOKOGAWA



EUROPEAN HEADQUARTERS

Yokogawa Europe B.V.
Databankweg 20
3821 AL AMERSFOORT
The Netherlands
Tel. +31-33-4641 611
Fax +31-33-4641 610
E-mail: info@yokogawa.nl
www.yokogawa-europe.com

THE NETHERLANDS

Yokogawa Nederland B.V.
Hoofdveste 11
3992 DH HOUTEN
Tel. +31-30-635 77 77
Fax +31-30-635 77 70

AUSTRIA

Yokogawa Austria Ges.m.b.H.
Franzensbrückenstrasse 26
A-1021 WIEN
Tel. +43-1-2165 043 0
Fax +43-1-2165 043 33

BELGIUM

Yokogawa Belgium N.V./S.A.
Minervastraat 16
1930 ZAVENTEM
Tel. +32-2-719 55 11
Fax +32-2-725 34 99

FRANCE

Yokogawa France S.A.
Vélizy Valley
18-20 Rue Grange Dame Rose
78140 VELIZY VILLACOUBLAY
Tel. +33-1-39 26 10 00
Fax +33-1-39 26 10 30

GERMANY

Yokogawa Deutschland GmbH
Berliner Strasse 101-103
D-40880 RATINGEN
Tel. +49-2102-4983 0
Fax +49-2102-4983 22

HUNGARY

Yokogawa Hungaria Ltd.
Alkotas Center 39 C
1123 BUDAPEST
Tel. +36-1-355 3938
Fax +36-1-355 3897

ITALY

Yokogawa Italia S.r.l.
Vicolo D. Pantaleoni, 4
20161 MILANO
Tel. +39-02-66 24 11
Fax +39-02-645 57 02

SPAIN

Yokogawa España S.A.
C/Francisco Remiro, N°2, Edif. H
28028 MADRID
Tel. +34-91-724 20 80
Fax +34-91-355 31 40

UNITED KINGDOM

Yokogawa United Kingdom Ltd.
Stuart Road, Manor Park,
RUNCORN
Cheshire WA7 1TR
Tel. +44-1-928 597100
Fax +44-1-928 597101

AUSTRALIA

Yokogawa Australia Pty Ltd.
Private mail bag 24
Centre Court D3
25-27 Paul Street North
NORTH RYDE, N.S.W. 2113
Tel. +61-2-805 0699
Fax +61-2-888 1844

SINGAPORE

Yokogawa Engineering Asia Pte. Ltd.
11, Tampines Street 92
SINGAPORE, 528872
Tel. +65-783 9537
Fax +65-786 2606

JAPAN

Yokogawa Electric Corporation
2-9-32, Nakacho, Musashino-shi
TOKYO, 180
Tel. +81-422 52 5617
Fax +81-422 52 0622

SOUTH AFRICA

Yokogawa South Africa (Pty) Ltd.
67 Port Road, Robertsham
Southdale 2135, JOHANNESBURG
Tel. +27-11-680-5420
Fax +27-11-680-2922

UNITED STATES OF AMERICA

Yokogawa Corporation of America
2 Dart Road
NEWNAN, GA 30265-1040
Tel. +1-770-253 70 00
Fax +1-770-251 28 00

ISO 9001



CERTIFICATED FIRM

CENTRAL/EAST REGION

Via Yokogawa Austria:
Czechia, Slovakia, Poland,
Croatia, Slovenia, Yugoslavia,
Bulgaria, Romania, Macedonia,
Bosnia & Herzegovina

Distributors in:

Denmark, Finland, Greece,
Norway, Portugal, Russian
Federation, Sweden, Switzerland
and Turkey.